

# CartStopBR

Steel leg Box Rail System - 'Riv Nut' Assembly

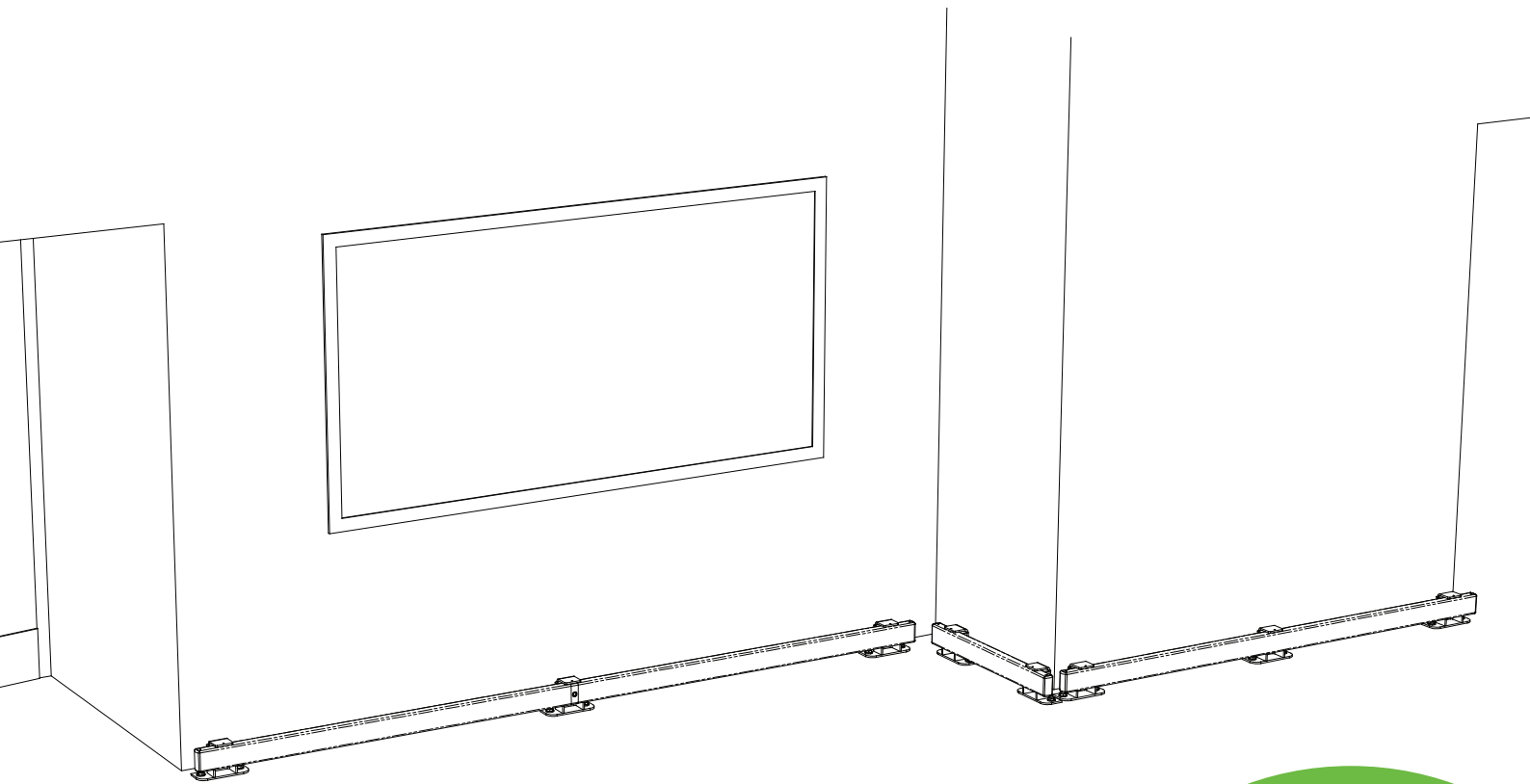

# Box Rail Components

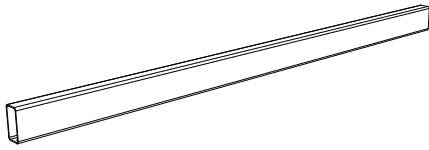

**80 x 40mm Box Rail**  
**Pt No: WHB-BR2900**

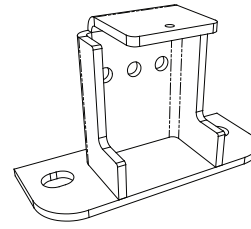

**Low Ground Leg**  
**Pt No: WHB-LGL**

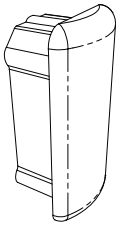

**Box Rail End Cap**  
**Pt No: WHB-DEC**

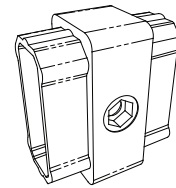

**Box Rail Joiner**  
**Pt No: WHB-JOINER**

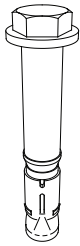

**Heavy Duty M12 Anchor**  
**Pt No: FXG-M12-100**

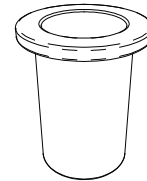

**M10 Rivnut**  
**Pt No: FXG-M10-RIVNUT**

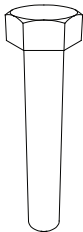

**M10 Bolt**  
**Pt No: FXG-M10-60-BOLT**

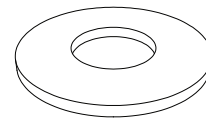

**M10 Penny Washer**  
**Pt No: WHB-JOINER**

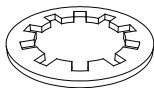

**M10 Toothed Washer**  
**Pt No: FXG-M10-SPRING-WAS**

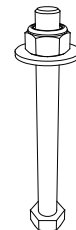

**Low Ground Leg Joiner Bolt**  
**Pt No: WHB-LGL-JOINER-BOLT**



**Tension Pin**  
**Pt No: WHB-PIN**

# Tools & Equipment



**Pencil/Marker &  
Chalk Line**

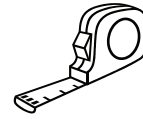

**Tape Measure**

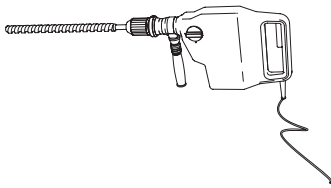

**Hammer Drill**



**Hand Drill**

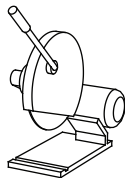

**Chop Saw  
(Suitable for cutting steel)**

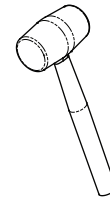

**Rubber Mallet**

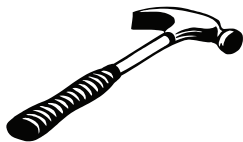

**Claw/Flat Pein Hammer**



**4mm HSS Drill Bit  
12.5mm HSS Drill Bit**

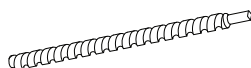

**20mm SDS Drill Bit  
(Hammer drill bit)**

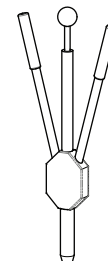

**Rivnut Tool**



**Nut Runner/Impact Driver**

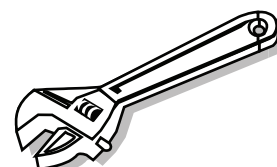

**Wrench/Socket Set**



# Box Rail Installation Details

## 1.1. Offset from fixture

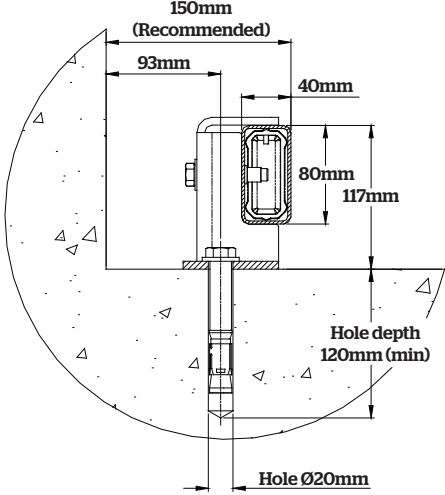

## 1.2. External Corner Layout

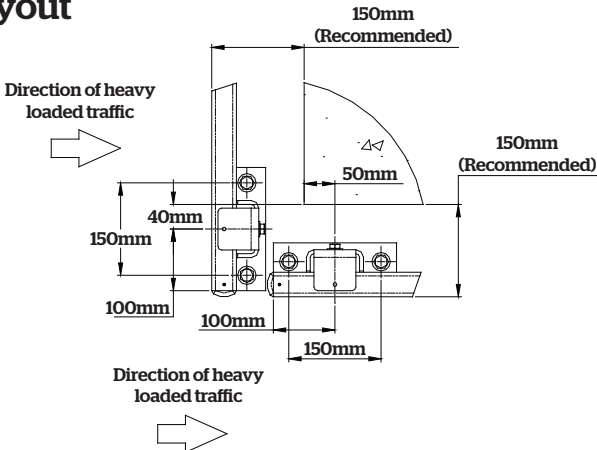

## 1.3. Internal Corner Layout

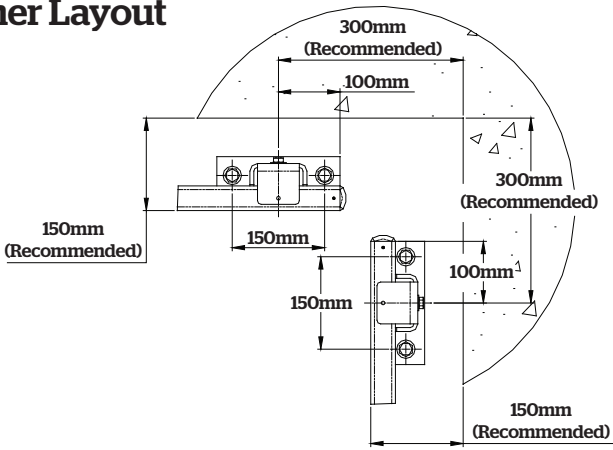



# Box Rail Installation Details

## 2.0. Single Rail Assemblys

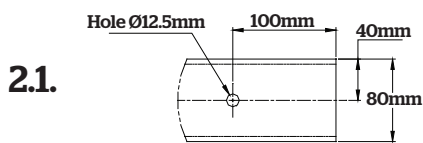
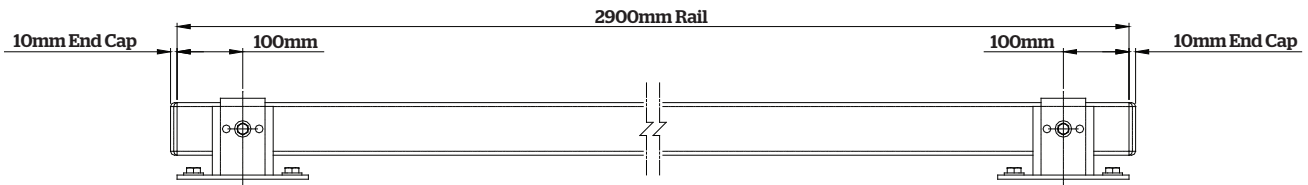

**Drill a 12.5mm diameter hole 100mm from each of the box rail**

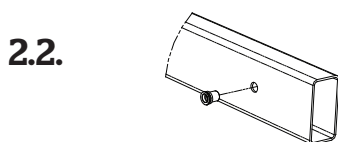

**Insert as M10 rivnut into each drilled hole and using the rivnut tool secure the rivnut in position**

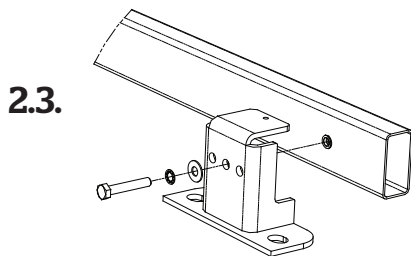

**Using M10 bolt washer and toothed washer assemble legs to rail**

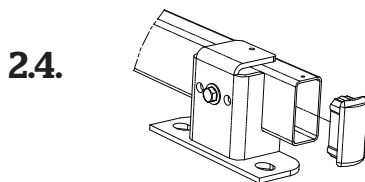

**Insert the domed end cap into the end of the rail (each where required)**

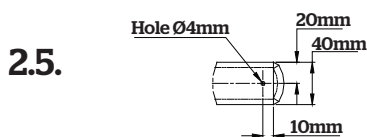

**Using the drill and a 4mm HSS drill bit drill a 4mm diameter hole through the rail and end cap from the 40mm top face**

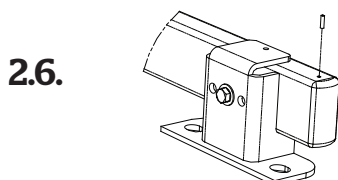

**Using the tension pin and a hammer secure the end cap in to the rail**



# Box Rail Installation Details

## 3.0. Joining Rail Assembly

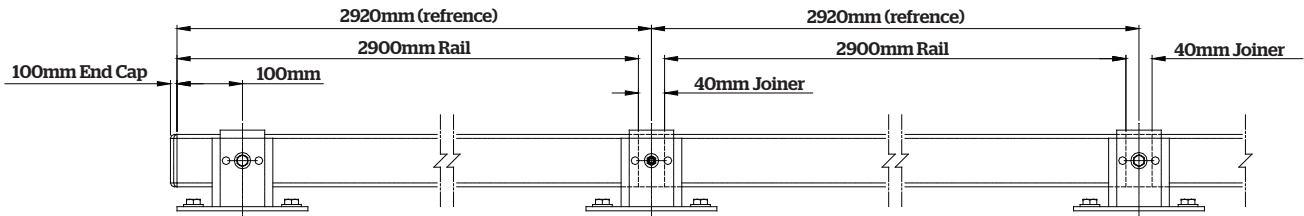

3.1.

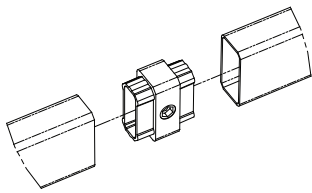

Insert joining spigot into each end of the rail requiring joining (ensure the hexagon recessed hole is positioned on the front of the rail)

3.2.

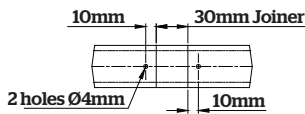

Using the drill and the 4mm HSS drill bit drill a 4mm diameter hole through the rail and joiner on both sides of the join from the 40mm top face

3.3.

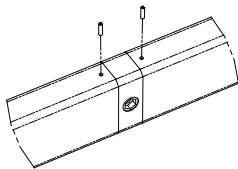

Using the tension pin and a hammer secure the joining spigot both joints to the rails

3.4.

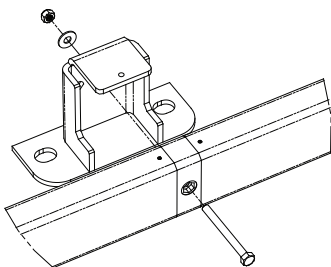

Using the Low Ground Leg Joiner Bolt fixings join the leg to the joiner and rails

3.5.

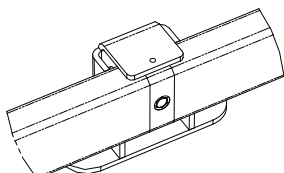

Ensure all components are secure



# Box Rail Installation Details

## 4.0. Mid Rail Support Leg

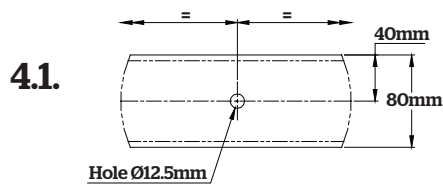
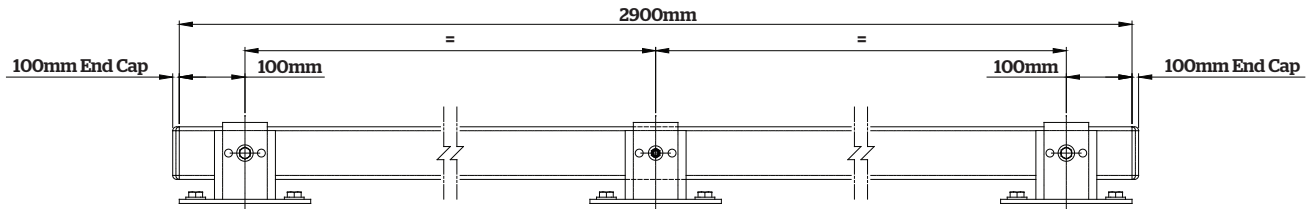

**Drill 12.5mm diameter hole at the mid point of the box rail**

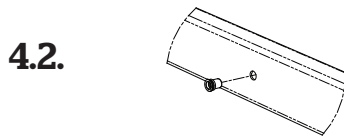

**Insert an M10 rivnut into the drilled hole and using the rivnut tool secure the rivnut in position**

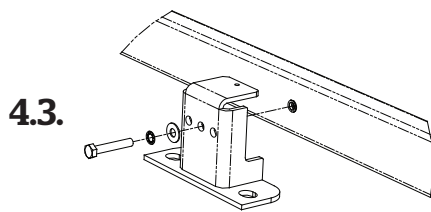

**Using the M10 bolt washer and toothed/spring washer assemble the leg to the box rail**

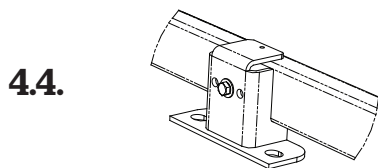

**Ensure all components are secure**

# Box Rail Installation Details



## 5.0. Measuring, marking out and drilling

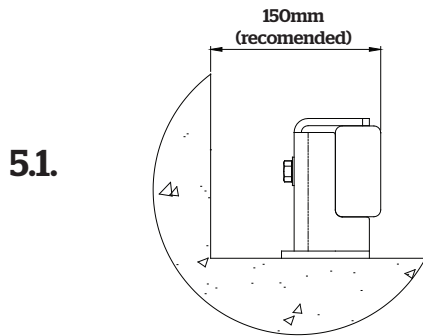

**Position the assembled rail approximately 150mm off of the fixture to be protected**

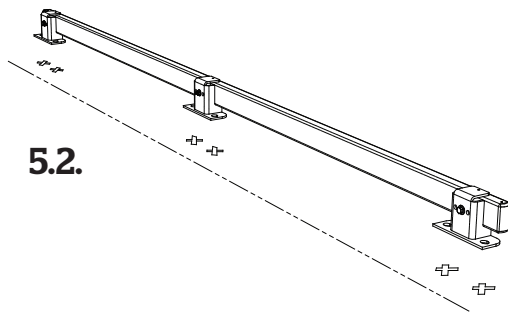

**Using the box rail leg fixing holes as a template mark out the fixing holes to be drilled**

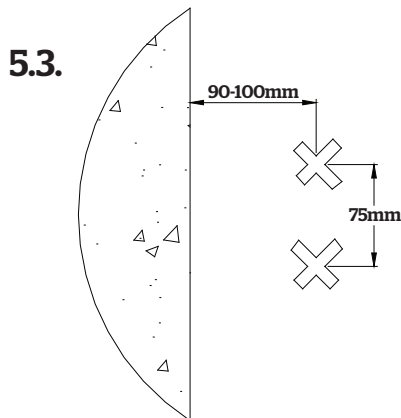

**Ensure the marked fixing hole are between 90 and 100mm from fixture**

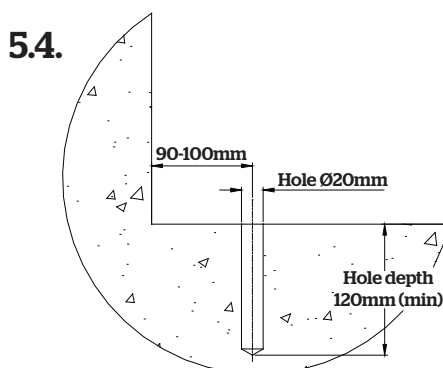

**Using a 20mm masonry bit and SDS drill, dril the fixing holes to a depth of approximately 120mm and clear away all debris**





# Box Rail Installation Details

## 6.0. Bolting Down and Securing Box Rail

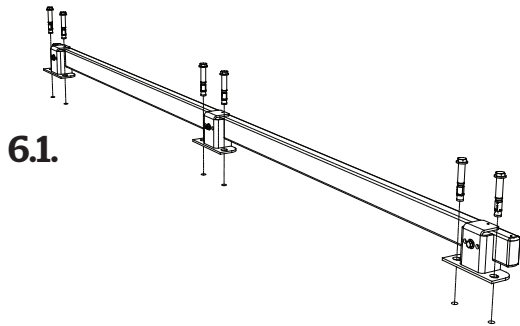

Position the boxrail back over the drilled holes, insert the Heavy Duty M12 Anchors

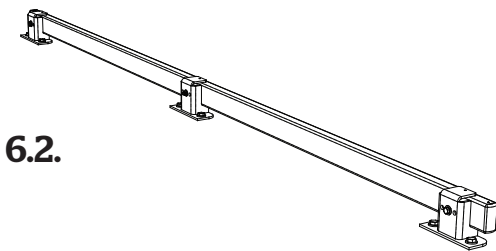

Once all the bolts are inserted and installed corectly using a nut runner/impact driver secure the legs and rail down to the ground

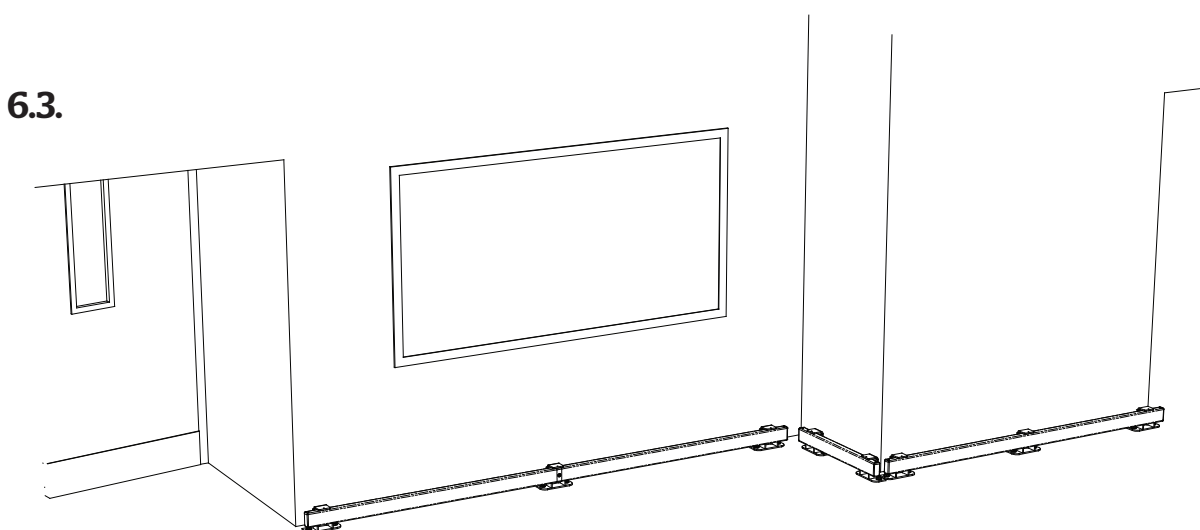

**Complete Box Rail installation. Clean of Box Rail of any debris, clear the install site of any debris and tooling. Give the install a 'once over' ensuring that all components are fixed and secure and the install is clear**